

19th Annual

KRHA CONFERENCE

WKU Knicely Conference Center, Bowling Green, KY

November 16-17, 2017



#PowerofRural



Objectives

At the end of this conference, participants will be able to:

- Build an overview of the state of rural health in KY
- Understand current initiatives to improve rural health services in KY
- Become a skilled advocate & promoter for rural health at the local, regional, and state levels

Continuing Education

Continuing education credits will be applied for as follows:

Physician/Nursing Home Administrator

The Southern Kentucky Area Health Education Center is accredited by the Kentucky Medical Association (KMA) to sponsor continuing medical education for physicians. The Southern Kentucky Area Health Education Center designates this live activity for a maximum of seven and one-half (7.5) *AMA PRA Category 1 Credits™*. Physicians should claim only credit commensurate with the extent of their participation in the activity.

Physician Assistant/Nurse Practitioner

This program has been approved by the Southern Kentucky AHEC for 7.5 hours Category 1 non-physician attendance.

Dentistry

This program has been approved by the Southern Kentucky AHEC for 7.5 hours Dentistry Credit.

Nursing

Rockcastle Regional Hospital, Inc. has been approved as a provider of continuing education by the Kentucky Board of Nursing (KBN). Provider #4-0059-12-18. Expiration Date: Dec. 31, 2018. Kentucky Board of Nursing approval of an individual nursing education program does not constitute endorsement of program content.

Agenda

Thursday, Nov. 16



7:00 am – 9:00 am

Exhibitor Setup
Knically West Lobby

8:00 am – 5:00 pm

Registration Open
Knically West Lobby

9:00 am – 10:00 am

Exhibit Hall & Poster Presentations Open
Knically West Lobby

10:00 am – 10:15 am

Opening Ceremonies
Andrew Bledsoe & Tina McCormick
Rm 208 ABDE

10:15 am – 10:30 am

Welcome to Bowling Green
Dr. Todd R. Cheever, MD
Rm 208 ABDE

1:30 pm – 2:30 pm

Break Out Session 1

Issues that Affect Reimbursement: An Update on Significant Developments for Your Rural Health Clinic

Lisa English Hinkle, Sarah E. Hines
Rm 208 C

Kentucky Telehealth Update 2017

Timothy Bickel, CTPM;
Donna Venio
Rm GH

10:30 am – 11:45 am

Keynote: Generational Engagement and Managing Change

Mark A. Noon, Studer Group
Rm 208 ABDE

11:45 am – 12:15 pm

Networking Break
Exhibit Hall & Poster Presentations Open
Knically West Lobby

12:15 pm – 1:15 pm

Lunch
Membership Meeting
Andrew Bledsoe, Noel Harilson,
Tina McCormick
Rm 208 ABDE

1:15 pm – 1:30 pm

Transition Break

Affecting Change in Kentucky's Rural Communities Through the Nutrition Education Program (EFNEP and Snap-Ed)

Marisa Aull, Martha Yount
Rm 208 F

Kinship: Healing Families Touched by Addiction

Kimberly Hinkel, MSSW
Rm IJ

Value Based Payment and Medicare Access and CHIP Reauthorization ACT (MACRA) Overview

Trudi Matthews
Regency Room

Agenda

Thursday, Nov. 16

2:30 pm – 2:45 pm

Transition Break

2:45 pm – 3:45 pm

Break Out Session 2

Opportunities for KY Rural Hospitals with Accountable Care Strategies

*Lisa Kilawee, MPA; Vicky McFall, RN
Rm 208 C*

Bingocize®: An Evidence Based Health Promotion Program for Improving Functional Performance, Social Engagement, and Health Knowledge in Rural Older Adult Communities

*Kathryn Dispennette; Lauren Stevens; Brian Clark; Jean Neils-Strunjas, PhD, CCC-SLP
Rm 208 GH*

3:45 pm – 4:15 pm

Networking Break

Exhibit Hall & Poster Presentations Open
Knically West Lobby

4:15 pm – 5:15 pm

General Session

County Health Rankings & Roadmaps
*Mary Bennett, MFA, Community Coach
Rm 208 ABDE*

Kentucky AHEC: Connecting Students to Health Careers

*David Gross, MPA; Dwain Harris, MHA;
Michael Gayheart, LNHA;
Rose Mueller, MA
Rm 208 F*

Revenue Integrity: The Impact of Clinical Validation Denials and ICD-10 Coding Changes

*Lynette Thom, RHIT, CCS, CDIP, ICD-10 Trainer
Rm 208 JJ*

Palliative Care: An Indispensable Ingredient to Successful Population Health Management

*Turner West, MPH, MTS; Liz Fowler, MPH;
Jill Conway
Regency Room*

5:15 pm – 5:30 pm

Announcements

*Tina McCormick
Rm 208 ABDE*

5:30 pm

Silent Auction Closes

TBD

Silent Auction

KRHA invites you to participate in our silent auction on Thursday, Nov. 16. The proceeds will benefit Student Chapters and other student activities! The auction closes at 5:30 pm and all payments must be made by Friday morning, Nov. 17.

If you are donating, please drop off items to the auction table located in/near the exhibit hall before 9:00 am Thursday, Nov. 16.

Physical Therapy

This program has been submitted to the KY Physical Therapy Association for PT credit. (Credit Pending)

Pharmacy

This program has been submitted to the KY Board of Pharmacy for pharmacy credit. (Credit Pending)

Respiratory

This program has been submitted to the KY Board of Respiratory Care for Respiratory credit. (Credit Pending)

Emergency Medical

This program has been submitted to Kentucky Board of Emergency Medical Services for Emergency Medical credit. (Credit Pending)

Certified Health Education Specialist (CHES)

This program has been submitted to the South Central AHEC for CHES credit. (Credit Pending)

Target Audience

Physicians, Physician Assistants, Dentists, Respiratory Therapists, Nurses, Nurse Practitioners, Nursing Home Administrators, Physical Therapists, Pharmacy, Psychology, Emergency Medical, Certified Health Educators, and other interested healthcare professionals

Participants must stay for the entire session and complete an evaluation to be awarded contact hours.

Special Needs

Please let us know if you have any special needs (i.e. physical, dietary, etc.)

Agenda

Friday, Nov. 17

6:30 am – 7:30 am

Fun Run/Walk

Hyatt Place Main Lobby

7:30 am – 8:30 am

Continental Breakfast

Exhibit Hall Open

Knically West Lobby

7:30 am – 10:00 am

Registration Open

Knically West Lobby

8:30 am – 9:30 am

Break Out Sessions

Creating Policy, Systems, and Environment Change Through the Plan4Health Initiative

Madri Hall-Faul, MSSW, CSW;

Barbara Gordon, MA

Rm 208 C

AHEC Ventures into Workforce Development

Lucy Juett, Martha Pleasant, Missy Stokes

Rm 208 F

Recording the Stories of Those Serving Rural Kentucky with the StoryCorps App

Catherine Malin

Rm 208 JJ

The Commission for Children with Special Health Care Needs: Improving Access to Care in Rural Kentucky; Initiatives, Partnerships and Collaborations

Karen Rundall, MSN; Judith Ann Theriot,

MD, CPE; Catharine Lester, MSSW;

Ivanora Alexander

Rm 208 GH

9:30 am – 10:00 am

Networking Break

Exhibit Hall Open

Knically West Lobby

11:15 am – 12:15 pm

General Session

Kentucky HEALTH

Overview

Adam Meier, Office of the Governor

Rm 208 ABDE

10:00 am – 11:15 am

General Session

Rural Policy Update

Brock Slabach,

NRHA

Rm 208 ABDE

12:15 pm – 12:30 pm

Closing Remarks

Noel Harilson &

Tina McCormick

Rm 208 ABDE

Hotel Info

Hilton Garden Hill

1020 Wilkinson Trace

Bowling Green, KY 42103

Phone: 270.781.6778

www.hiltongardeninn.com

Group Block Code: KRHA

Nightly Rate: \$119 plus tax

Hyatt Place

1347 Center Street

Bowling Green, KY 42101

Phone: 270.467.0001

www.bowlinggreen.place.hyatt.com

Group Block Code: KRHH

Nightly Rate: \$93 plus tax

Reserve by: 10/15/17

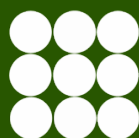

HYATT
PLACE

Facility Map

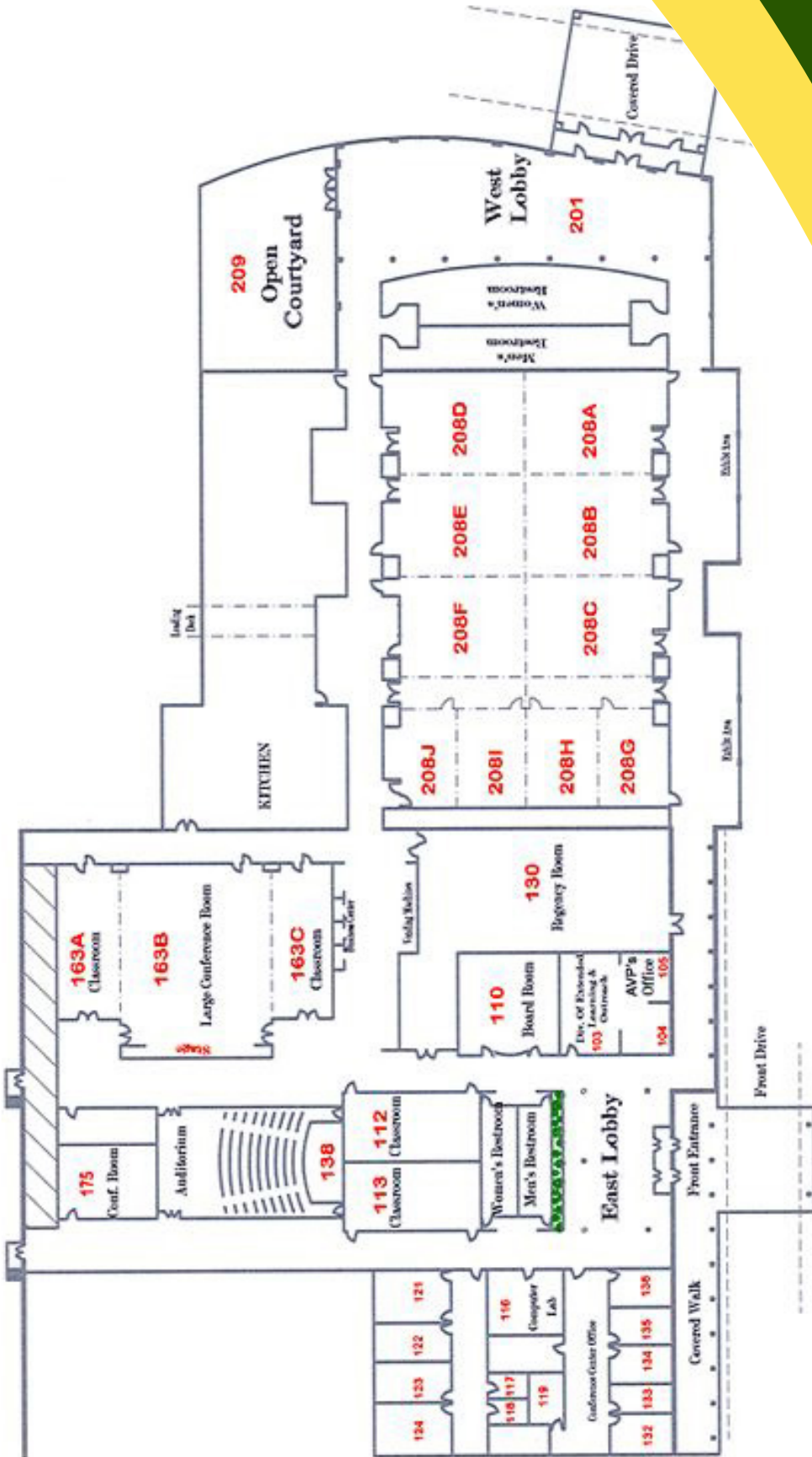

Payment Info

Make check or money order payable to the **KRHA** and mail with your completed registration form.

KRHA Members

- Regular: \$125
- Late (after Nov. 1): \$175

Non-KRHA Members

- Regular: \$175
- Late (after Nov. 1): \$225

Students

- KRHA Member: \$45
- Non-KRHA Member: \$55

Send paper forms to:

Tina McCormick
 Kentucky Rural Health Association
 36 South Alvasia
 Henderson, KY 42420
 krha@twc.com

Release of all Claims & Damages

This release of all claims and damages, if any, suffered by the undersigned as the result of property damage, bodily injury or death incurred by the undersigned at or during any event sponsored by the Kentucky Rural Hospital Association (KRHA), its successors and assigns, is more particularly set out hereinafter.

In consideration for the involvement and participation in the event sponsored by KRHA as more particularly set out Above, the undersigned hereby discharges, releases and agrees to indemnify KRHA, its representatives and officers, for all claims and demands whatsoever for any property damages, bodily injury or death caused by the participation of the undersigned and to indemnify KRHA from any claim for property damage, bodily injury or death caused by the undersigned.

The undersigned acknowledges the right to have this Release reviewed by a third party and accepts the same "as is" which is binding upon the undersigned, their heirs, successors and assigns and can only be amended by written agreement of all parties.

KRHA Registration

or register online at www.kyrha.org

Name: _____

First MI Last Suffix

Social: ***_**- **LIC #:** _____

(Nursing Only - Last 4 Required) (Required)

Address: _____

City: _____ **State:** _____ **Zip:** _____

Phone #: (H) _____ (W) _____ (C) _____

Organization: _____

Email: _____

Continuing Education Credits Needed: (Check all that apply)

- | | | |
|-----------------------------------------------------------------------------------------------------------------------------------------------------------------------------------------|----------------------------------------------|----------------------------------------|
| <input type="checkbox"/> Certified Health Education Specialist | <input type="checkbox"/> Nursing | <input type="checkbox"/> Respiratory |
| <input type="checkbox"/> County Official | <input type="checkbox"/> Pharmacy | <input type="checkbox"/> Social Worker |
| <input type="checkbox"/> Dentistry | <input type="checkbox"/> Physician | |
| <input type="checkbox"/> Nurse Practitioner | <input type="checkbox"/> Physician Assistant | |
| <input type="checkbox"/> Other (please specify and email kentuckyruralhealthassociation@gmail.com to verify availability) | | |

2 Mile Run/Walk Waiver

Friday, Nov. 17, 2017 | 6:30 am – 7:30 am
(only complete if you plan to participate)

Name: _____

Address: _____

Gender: M F

Shirt Size: Adult (S M L XL XXL)

- Registration begins at 6:00 am
- Awards provided to first place male and female
- Advance registration guarantees shirt

Participant Signature _____ Date _____